

NECKOG
INDUSTRIES

Flow

Quick Starter Guide

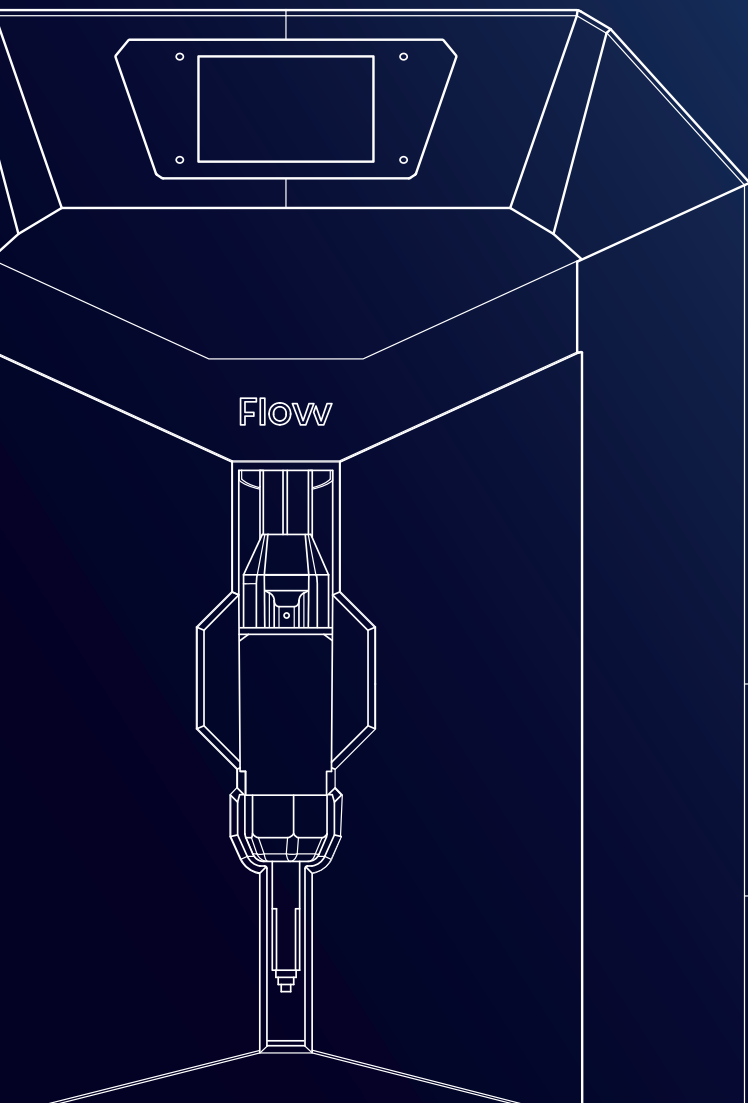

INTRODUCTION

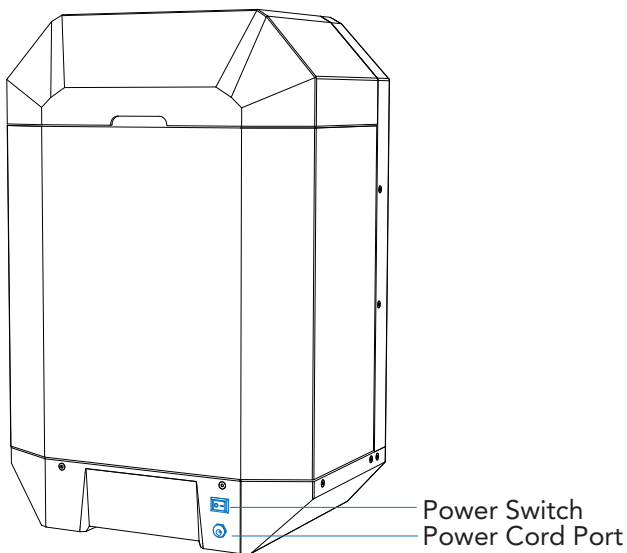
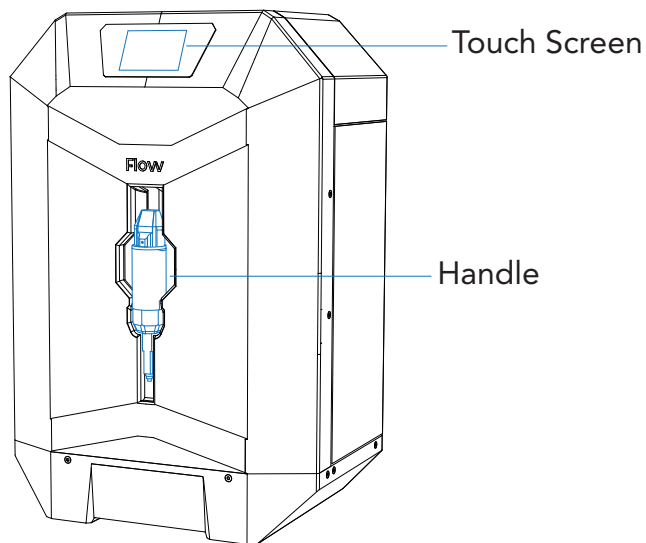

STARTING UP

Carefully remove all components from the packaging

Ensure all included part are present

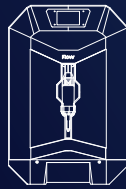

Injection Module



Injection Gun

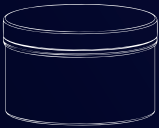

Mold Release

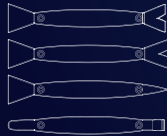

Prying Tools



Cleaning Tank



Resin Tanks (A&B)

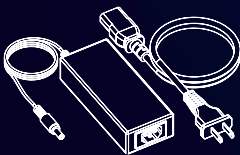

Power Adapter

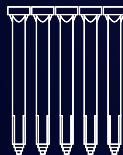

5 Spare Nozzles



User Manual



Working Pad

01 SETTING UP Flow

1. Position the Device

- Place Flow on a stable, ventilated surface.

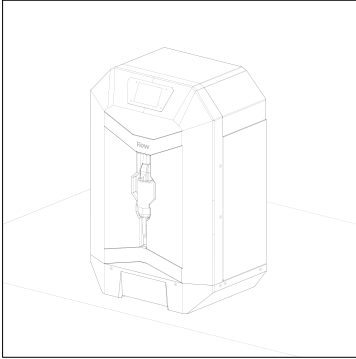

2. Connect Power

- Plug the power adapter into the device and a power outlet.

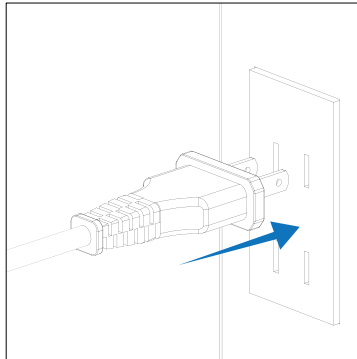
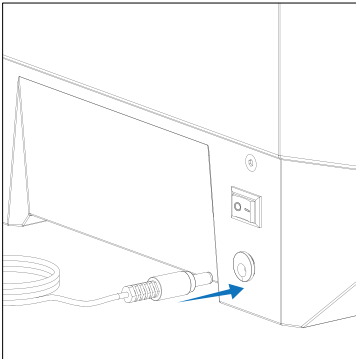

3. Check the Injection Gun

- The injection gun comes pre-installed.
- For instructions on changing the nozzle, refer to the “Nozzle Swap & Priming Calibration” section in the user manual.

4. Load Materials

- Open Resin A and Resin B tanks.
- Pour Resin A into Tank A and Resin B into Tank B.
- (Optional) Add color pigment to the appropriate tank depending on your resin type.
- Refer to the Color Pigment Data Sheet for guidance on which pigment should be added to Tank A or B.
- Open the Cleaning Tank and fill it with Neckog Cleaning Fluid.
- Close all tank caps tightly to avoid contamination or evaporation.

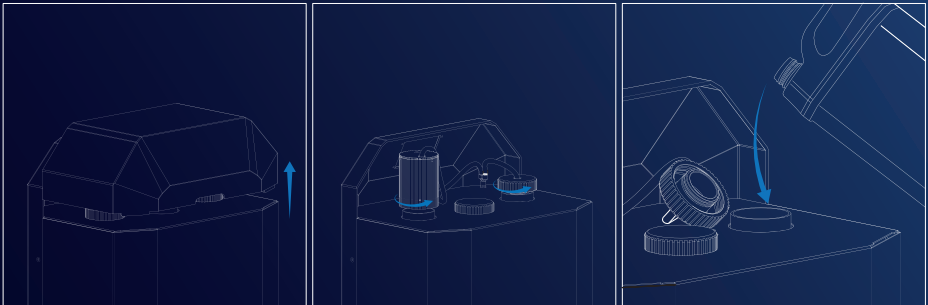

5. Power On

- Press the Power Switch. Wait for the touchscreen to show the home screen.

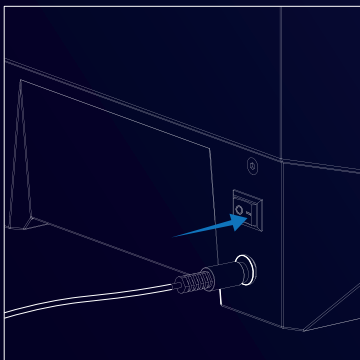

Need help?

Visit: store.neckog.com/support

Email: contact@neckog.com

02

First Injection

Select the material type from the touchscreen.

Adjust injection settings as needed.

Place the mold securely on the platform.

Press Start Injection and allow the device to mix and inject resin.

Wait for curing to complete.

Remove the mold and check for accuracy.

03

Cleaning & Maintenance

After every use, flush the system using the Cleaning Liquid to prevent clogs.

Remove the nozzle and clean any excess resin.

Store Flowv in a dry, dust-free environment.

04

Safety Guidelines

Use only in a well-ventilated area.

Wear gloves and avoid direct skin contact with resins.

Do not exceed recommended resin ratios.

Keep away from children.